

OTHER CAMPUS
PLANS





■ OTHER CAMPUS PLANS

Introduction

CCSF operates eleven campuses throughout the City of San Francisco in addition to the Ocean Avenue Campus. While the latter is the largest of the campuses, the others fill critical roles in assuring access to the varied programs that the College makes available.

Each of the eleven campuses is described further in the section that follows. For each campus, its location and program offerings are described. A discussion of facilities issues and plans are also provided. At this time two of the campuses, Mission and Chinatown/North Beach, are in the process of preparing major facilities plans. The others have a variety of smaller projects planned, generally comprising renovations and alterations to existing space.

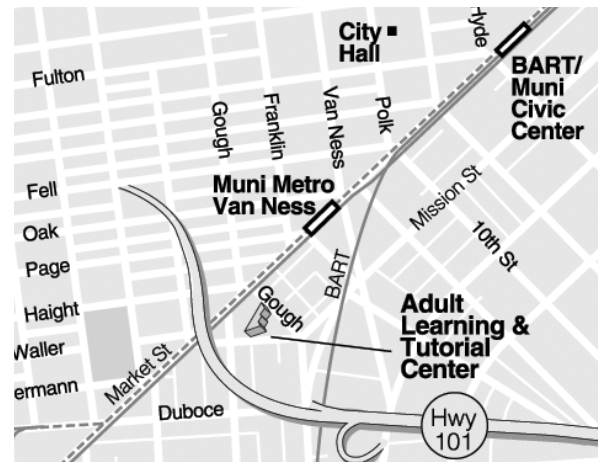
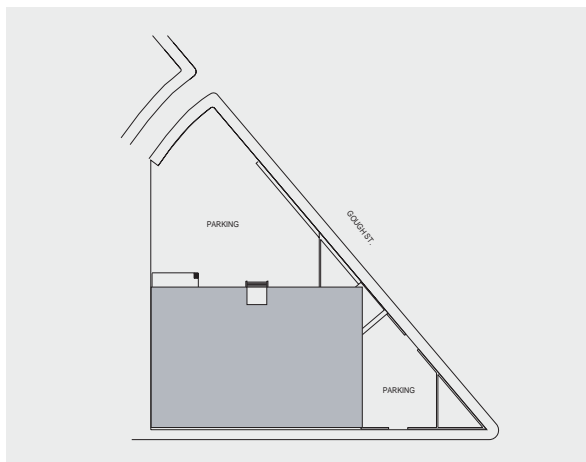

Administration/Adult Learning(1971)

Owned

31-33 Gough St.
San Francisco, CA 94103
36,328 ASF
50,521 GSF

- Administration
- Adult Basic Learning and Transitional Studies

The central administrative and financial offices of the College District are housed in an older building owned by the College, located just south of the intersection of Market and Gough Streets in San Francisco.

The building houses a number of College administrative and support facilities, including: central administrative offices, financial services, payroll, accounting, human resources, GED, testing, teacher resource center, adult education and re-entry programs.

The condition of the building is poor with renovations needed in terms of ADA accessibility, lighting, ventilation, toilet rooms and other needs.

No current facility plans exist for this building other than the removal of architectural barriers and the possible upgrading to ensure ADA compliance. The site is valuable due to its location

near Market Street and the Civic Center. The City encourages higher density in this area due to its good proximity to transit (BART and MUNI). This site lies in the middle of the Market and Octavia Better Neighborhoods Plan, where high-density housing and mixed use development are encouraged. The Planning Department would encourage the site to be redeveloped at a higher intensity of mixed use to include housing and other functions. The College may consider selling the site or redeveloping this site independently or in partnership with other entities (e.g. SFUSD).

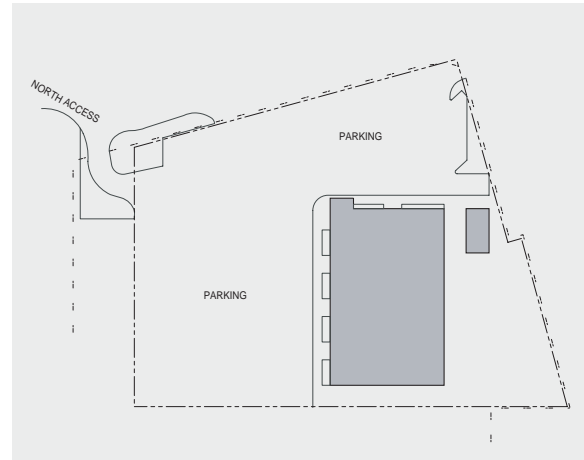

Airport Campus (1975)

Bldg. Owned/Site Leased

San Francisco International Airport
San Francisco, CA
20,776ASF
27,753 GSF

- Aircraft Technology
- Avionics

Located at the northern edge of San Francisco International Airport, the Airport School provides special programs in aeronautics.

The School is housed in a one-story, metal building containing classroom, shops and labs. The building also

contains offices, support and storage space. The District owns the building itself, and the site is leased from the Airport Commission. The airport plans to use this site for airport operations and, therefore, to relocate the Airport School, with a new site and a new building on or near the Airport. Some repairs and rehabilitation are needed in the current facility. The Airport Campus is expecting an increase from 6,108 WSCH(2000) to a 6,663 WSCH in 2005, although in the light of current crisis and cutbacks in the airline industry, the expected increase may not materialize.

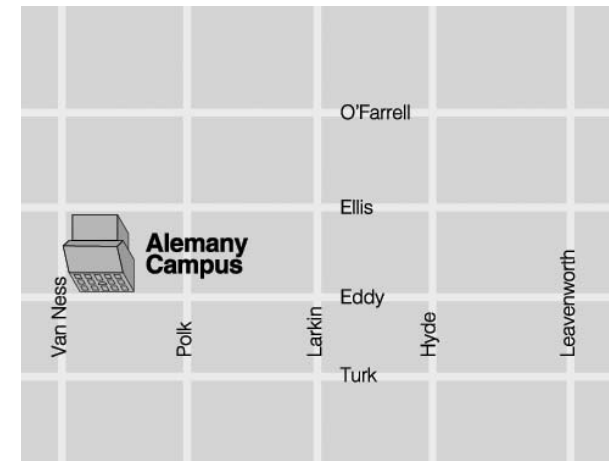
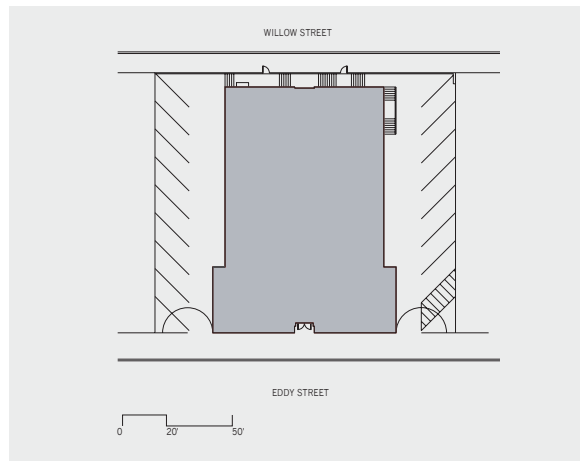

Alemany Campus (1911)

Owned

750 Eddy St.
San Francisco, CA 94109
15,668 ASF
26,400 GSF

- Citizenship
- Computer Studies
- ESL
- Vocational ESL Office Training Certification
- Computer Assisted Language Learning
- Keyboarding and ESL Social Communications

The Alemany Campus offers programs at: 750 Eddy St., A.P. Giannini Middle School (Sunset District), Park-Presidio Church (Richmond District), the Tenderloin Community School and Career Resources Development Center. This campus provides (ESL) English-as-a-Second Language and pre-vocational instruction to adults whose native language is not English. Over 95% of the classes at Alemany Campus are ESL. In the past five years, there has been a slight decrease in enrollment.

The campus is exploring the possibility of expanding the current site at Tenderloin Community School. There have been discussions on the establishment of office training programs in

which students would learn and perform using classroom modules, ranging from direct instruction to hands-on application. The Adult Learning Center at 31 Gough, which has Adult Basic Education and GED programs, may relocate its entire program to the Alemany Campus.

The College will also explore the possibility of weekend classes, perhaps to include credit classes and job training programs. Fire safety and seismic upgrade projects are planned. Additional rental space will be needed for the transference of the entire Adult Learning Center and Tutorial Program from 31 and 33 Gough building, which would be a few hundred additional

students. This would include main office and counseling spaces, tutorial rooms, and student eating and studying areas. A new location for the Park-Presidio off-campus site is necessary because the current facility is overcrowded and outdated.

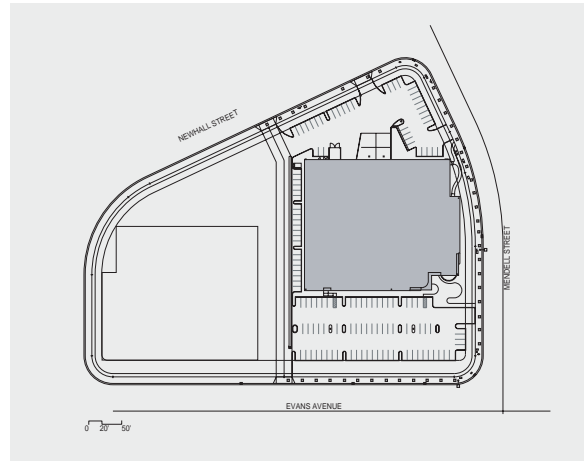

Evans Campus (1984)

Owned

1400 Evans Avenue
 San Francisco, CA 94124
 77,325 ASF
 90,000 GSF

- Apprenticeship
- Automotive Mechanics
- English
- Internet
- Math
- Trade Skills
- Office of Vocational Education
- Community Service Offices

The Evans Campus, the newest of the City College of San Francisco's campuses, opened in 1994. The original goal of the campus was to consolidate City College of San Francisco's Skilled Trades and Automotive Programs at one site.

Evans is the center for other training programs, including a DHS-funded (Department of Human Services) Center for Construction and Maritime Training, and is the preeminent West Coast teaching factory for the apparel and garment trades and industry. Evans has approximately 2,000 students.

The college has purchased the Evans Campus and is renovating and remodeling the facility so that it can be the focus of an expanded mix of vocational and technical programs. The intent would be to complement the offerings at the Southeast Campus.

The Evans Campus plans to expand the Construction and Maritime Trades Training Center and develop a transportation hub, including automotive, aeronautics, railroad, maritime, and intelligent transportation system.



Southeast Campus (1986)

Leased

1800 Oakdale Avenue
San Francisco, CA 94124
27,658 ASF
38,650 GSF

- Vocational Nursing
- General Education
- Adult Basic Education
- ESL
- Fashion Design
- Computerized Machine Technology
- Word Processing
- Clerical/Secretarial

- Computer Studies
- Certificate Programs
(Credit & Noncredit)

The Southeast Campus is an outgrowth of the San Francisco Community College District's former Skills Center, which offered primarily vocational training classes.

This site is a San Francisco City and County-owned community facility intended to house an educational program, a child care program, a community meeting room and a program for senior citizens. The current tenants in the facility are a Head Start child care

program, City College of San Francisco, and a community political action group.

City College of San Francisco is the anchor tenant in the facility, leasing approximately 85% of the building and enrolling approximately 1,200 students. The Southeast Campus serves the Bayview Hunter's Point, Potrero Hill and Visitacion Valley communities. It is well positioned to respond to the vocational and academic needs expressed by residents in the adjacent Bayview community and the city at large.

Southeast Campus and Evans Campus are developed to be complementary to each other and directly benefit the community.



Downtown Campus (1978)

Owned

800 Mission St.
 San Francisco, CA 94103
 44,602 ASF
 86,038 GSF

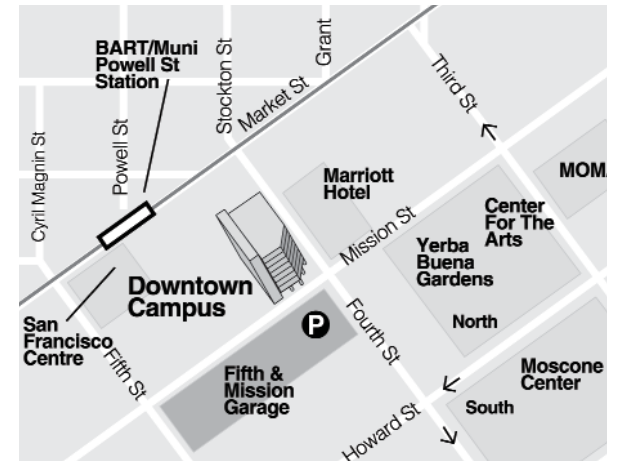
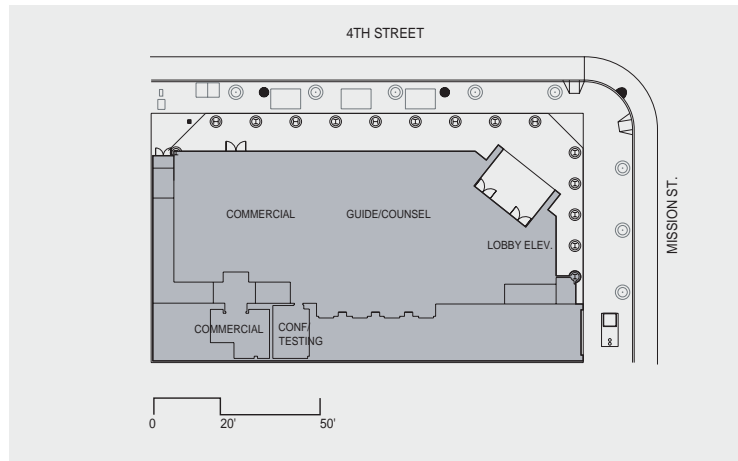

- Vocational ESL Office Training Certification
- Business Technology
- Food Technology and Dining Services
- Supervision and Management
- Contract and Continuing Education
- International and Small Business
- Labor Studies
- Word Processing
- Clerical Assistant
- Office of Business Education

The location and accessibility of the Downtown Campus are two of its main assets. Because of its proximity to the

business community and to public transportation lines, the campus is able to meet the training needs of local employers and the educational needs of a diverse group of students from all parts of the Bay Area.

The campus is remodeling the first floor, 2nd floor library, 5th floor computer labs and basement. When the dining room is relocated to the lobby area, the Culinary & Service Skills Training Program will experience a dramatic change in how it operates. The exposure of the dining room to pedestrian traffic on 4th and Mission Streets will mean hundreds of additional customers and will transform the Educated Palate into a high-volume,

vibrant restaurant. Plans for the space vacated by the dining room include the creation of a Center for Advanced Media & Animated Technologies; one of its key goals will be to meet the training needs of students who want to work in multimedia and other technology-based firms.

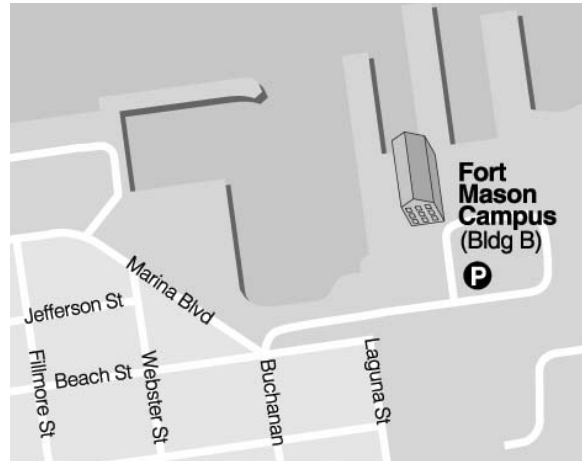

Fort Mason Campus (1934-Bldg. B)

Leased

Fort Mason Center, Bldg. B
Laguna and Marina Blvd.
San Francisco, CA 94123
16,948 ASF
24,000 GSF

- Ceramics and Sculpture
- Drawing and Painting
- Design
- Photography
- Printmaking
- Fine Artist and Business
- Older Adults Program
- Continuing Education Offices

The Fort Mason Campus is located in Building B on the First and Second floors.

Art is the primary focus of the campus, and constitutes 80% of the programs offered. The campus also offers Continuing Education programs. There are approximately 2,000 students enrolled at this campus.

Last year the campus facilities were upgraded. There are no further plans for modifications or renovations at this time.

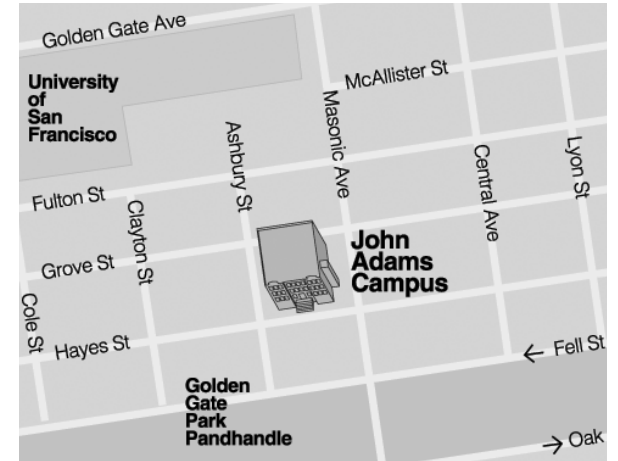
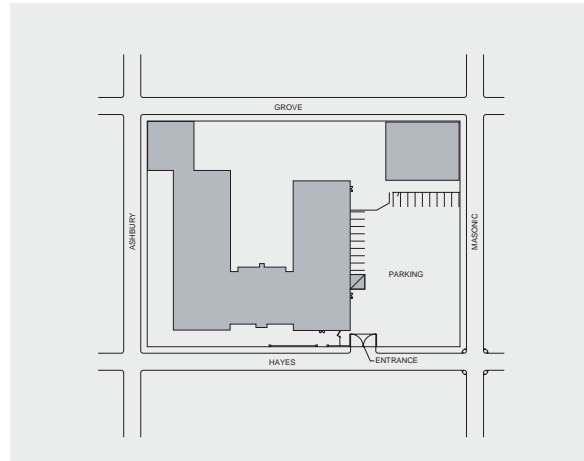

John Adams Campus (1911)

Owned

1860 Hayes St.
 San Francisco, CA 94117
 97,045 ASF
 151,397 GSF

- Business/Office Technology
- Child Development and Family Studies
- Disabled Students Program and Services
- ESL
- GED Assessment Center
- Health Care Technology
- Trade Skills/drafting
- Vocational Nursing

The John Adams Campus provides credit and noncredit programs to help students to acquire the necessary competencies to attain entry-level vocational positions. It is also in a position to assist immigrants with medical background to find new careers in the health care industry. In the 2001–2002 academic year the campus created an International Health Care Workers Center (IHCWC) on the John Adams Campus in collaboration with the Regional Health Occupations Resource Center (RHORC).

Over the last three years there has been a decline in ESL, Business and Allied Health enrollments.

The main building was constructed in 1911 and needs both major infrastructure and cosmetic repairs, as well as seismic and electrical/technology upgrades.

Improvements needed in this campus facility include: seismic upgrade of main building, remodel of bathrooms, library expansion, remodel of the lower level of gym building, exterior doors and window replacements, replace floors, remodel Vocational Nursing skills labs, remodel Counseling, Matriculation and Admissions and Records space, remodel gymnasium for use as a gym with fitness center, provide office space for faculty, upgrade electrical system, install technology network, signage for interior and exterior

of buildings, remodel DSP&S offices and remodel Room 202 to be a smart classroom. This work will be done in 2004.

A seismic upgrade to the gym building was completed and the remodeling began early in 2003, with programs moving into this space in spring 2004 semester. The plan is to return the gymnasium to its original state and expand PE offerings to include basketball, volleyball, aerobics, badminton, martial arts, and adaptive PE for DSP&S students. The main building is to be seismically upgraded in 2005.

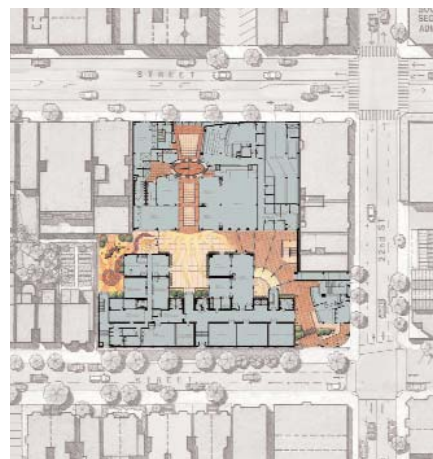

Mission Campus (1939)

Leased

106 Bartlett St.
San Francisco, CA
23,990 ASF
32,108 GSF

- ESL Program
- General Education
- Graphic Communications/
Printing Programs
- Certificate Programs
- Office Technology
- Working Adults Degree Program
- Older Adults Program
- Transitional Studies

The Mission Campus offers access to affordable credit and noncredit courses and programs tailored to the needs of Mission District residents at the 106 Bartlett facility and eight different neighborhood sites. The Campus offers a comprehensive Transitional Studies Program and a complete English as a Second Language Program. They prepare students to enter the vocational programs while the Working Adults Degree Programs offer credit courses at convenient times for adults.

The Mission District is ethnically diverse and its residents have multiple needs. The Mission Campus is the

administrative office for the Older Adults Department, which offers classes in 41 different locations throughout the city and addresses the needs of an ever increasing and significant population.

New Directions

The college has recently signed a 75-year ground lease for the building located at 106 Bartlett Street and the adjacent open site on Valencia Street. The building is currently in the design phase for renovation and expansion. There will be two buildings on these sites after construction is complete. Two thirds (2/3) of the increased

enrollment at the new campuses is expected to be served at the new Mission Campus.

It is anticipated that the new Mission Campus will be ready for occupancy by the year 2006. The new building will be a state of the art educational facility with traditional classrooms, as well as specialized classrooms and dedicated spaces. The anticipated population growth in the neighborhood will be served according to the emerging needs.

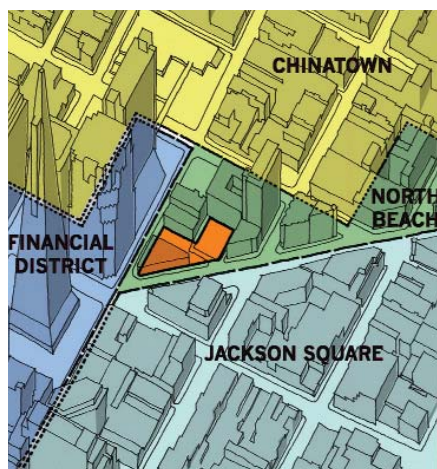

Chinatown/North Beach Campus(1911)

*Leased
plus 12 satellite locations*

940 Filbert St.
San Francisco, CA 94133
19,538 ASF
35,822 GSF

- Accounting
- Citizenship
- Vocational ESL Office
Training Certification
- Computer Studies
- ESL, ESL Citizenship,
Vocational ESL
- Home Health/Aid
- Housekeeping
- Foreign Language
- Business
- Child Development
- Health Science
- Real Estate
- Chinese Medicine

As of 2003 the Chinatown/North Beach Campus occupies 10 locations. All sites are leased and shared-use facilities. There are approximately 7100 students served seven (7) days a week and four (4) weekday evenings.

New Directions

The college is designing a new facility bordering the Chinatown, North Beach, and Financial Districts. Construction will be complete in 2006.

In the meantime, the facilities will be remodeled to support the needs of new, modified or expanded courses/programs. Of immediate need is the upgrading of electrical wiring to support the four computer labs currently in place. One third (1/3) of the increased enrollment at the new campuses will be served at the new Chinatown/North Beach Campus.

The new campus will include dedicated classroom space, expanded offices, student activity areas, (i.e. student lounge, library with a learning resource center and tutorial services, childcare center, bookstore), faculty work areas, and conference rooms. The building will be designed so that the community can make use of the space for workshops, or mini-conferences, including an auditorium, multi-purpose space, and an art gallery.



Castro/Valencia Campus (1930'S)

Leased

James Lick Middle School
1450 Church St.
San Francisco, CA 94114



- Behavioral Sciences
- Health Sciences
- Writing, Art, Music
- Business
- Foreign Languages
- Gay, Lesbian and Bisexual Studies
- Social Sciences
- Counseling Services
- Humanities
- Women's Studies

The Castro/Valencia Campus provides access to courses and programs that fulfill general education, Associate degrees, transfer, and Award of Achievement requirements. The Campus provides extensive foreign language instruction to prepare students to function in diverse local and global commu-

nities. The Castro/Valencia Campus originated as an educational center for San Francisco's gay, lesbian, bisexual, and transgender communities, and this curriculum and outreach to those communities continues to be an essential part of the campus' mission.

The most recent data from the Office of Research show that the Castro/Valencia Campus has the second highest credit enrollment among all of the CCSF campuses.

If facilities can be found, there are many opportunities for program development in the Castro/Valencia (and Noe Valley) area. Demographic predictions for the next five years include an aging population in each of the three geographic areas that

make up the highest percentage of Castro/Valencia students: the Haight; Noe Valley; and the Mission. Recent enrollment patterns suggest there is a demand for additional Social and Behavioral Science classes, some Health and Guidance courses and certain art classes.

