

# Creative Matting Guide

**Detailed Instructions on how to cut more creative style mats**

**Including: The Double Mat  
The Off-set Corner Mat  
The Inlay Mat**



# Creative Matting Guide

## A. Double Mats (Example 8" x 10")

### Materials Needed: Double Sided Tape

- Step 1: Set the Mat Guide to 2" and cut an opening in the mat from the BACK.
- Step 2: Keeping the fallout piece in place, run double-sided tape around the back of the window border. Do not put tape on cut line. Also put a small swatch of tape in the center of the fallout.
- Step 3: Straight Cut a second mat of a different color to an outside dimension of approximately 7 1/2" x 9 1/2".
- Step 4: Affix the second mat FACE DOWN to the taped back of the first mat being sure to center it reasonably well.
- Step 5: Set the Mat Guide to 2 1/4" and cut the second opening. The double fallout will drop from the window and the mat will be finished and perfectly aligned. NOTE: Triple mats can be achieved by repeating the above procedures a further time.

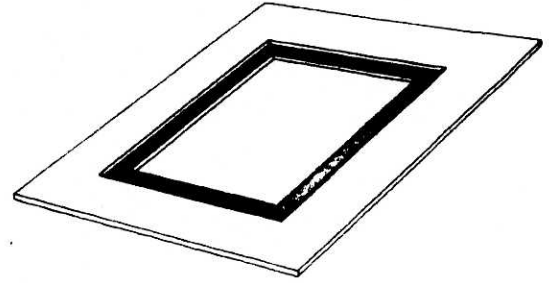

## B. Off-Set Corner Mats (Example 8" x 10")

- Step 1: Set the Mat Guide to 2" and draw all four lines.
- Step 2: Reset the Mat Guide to 1 1/2" and draw another set of lines.
- Step 3: Leaving the Mat Guide set at 1 1/2", place the mat in the cutter, put on the Cutting Head and line up the silver indicator line with the bottom drawn pencil line closest to the center of the mat. Cut until the silver indicator lines up with the top pencil line closest to the center of the mat. Using the same procedure, cut all four sides. IMPORTANT: At this point the fallout will not drop from the window. Continue.
- Step 4: Remove the mat and reset the Mat Guide to 2". Reinsert the mat.
- Step 5: Line up the silver line on the Cutting Head with the drawn pencil at the bottom line furthest from the center of the mat. Cut until the Bevel Cutting Head lines up with the line at the top of the mat furthest from the center of the mat. Using the same procedure, cut all four sides. NOTE: Be careful to hold the fallout piece in the window as you turn the mat for the last cut.

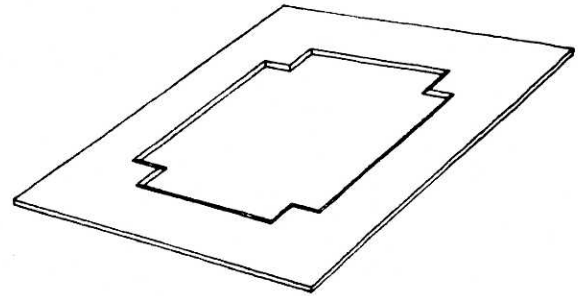

## Inlay Mat (Example 8" x 10")

### Materials Needed: Masking Tape

- Step 1: Set the Mat Guide at 2" and cut a mat as per regular procedures
- Step 2: Reset the Mat Guide at 1 1/2". Keeping the fallout in place, cut the mat again as per regular procedures. You may keep the fallout in place by taping it on the back.
- Step 3: Discard outer border piece and fallout. Retain inside border cutout.
- Step 4: Leaving Mat Guide in place at 1 1/2", cut a second mat of a different color as per regular procedures. IMPORTANT: The second mat must be of the exact same outside dimension as the first mat.
- Step 5: Remove the fallout piece from the second mat and place the inside border cutout from the first mat in the window opening from the second mat. The two pieces should fit together like a puzzle creating a flush surface across the front of the mat. Put tape on back to hold in place.

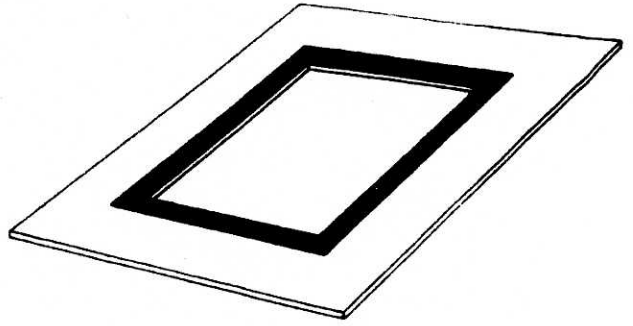

**For more creative ideas in matting, pick up a copy of Logan's *BASIC MAT CUTTING BOOK* by Vivian C. Kistler, cpf. Item #238**

**Available through Logan dealers.**

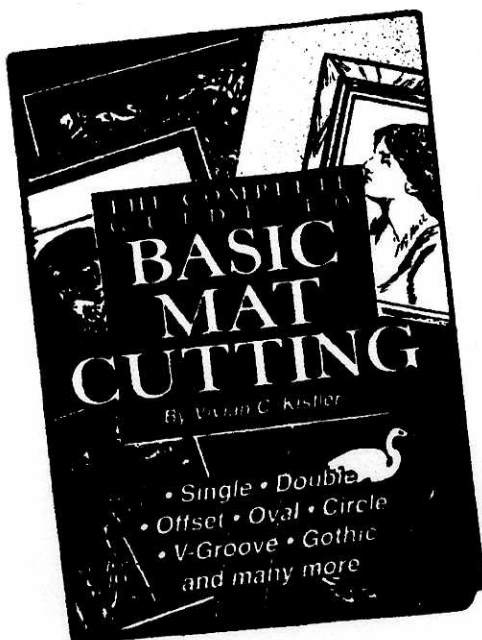

# Parts List

## A. Cutting Heads

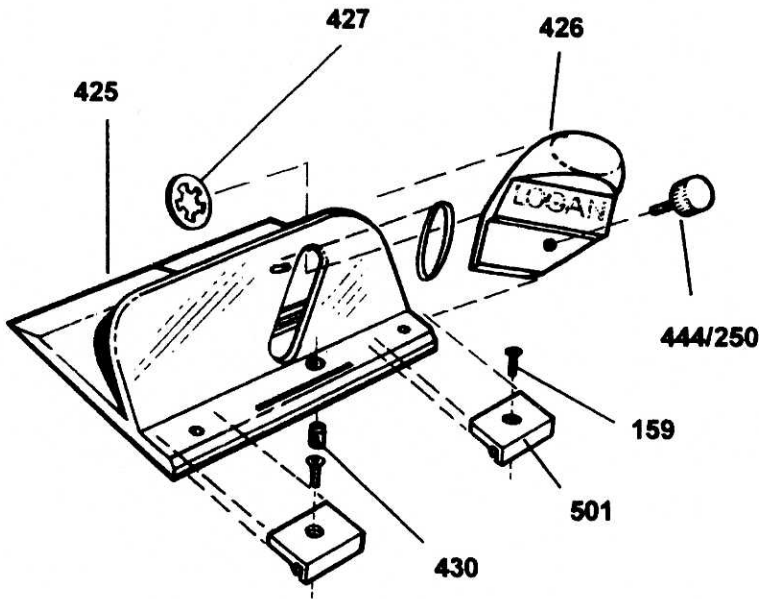

### 302 Bevel Cutting Head

427	Push Washer
425	Cutting Head Base
426	Push Slide
444/250	Blade Screw
501	Bearing x2
159	Bearing Screw x2
430	Depth Adj. Screw

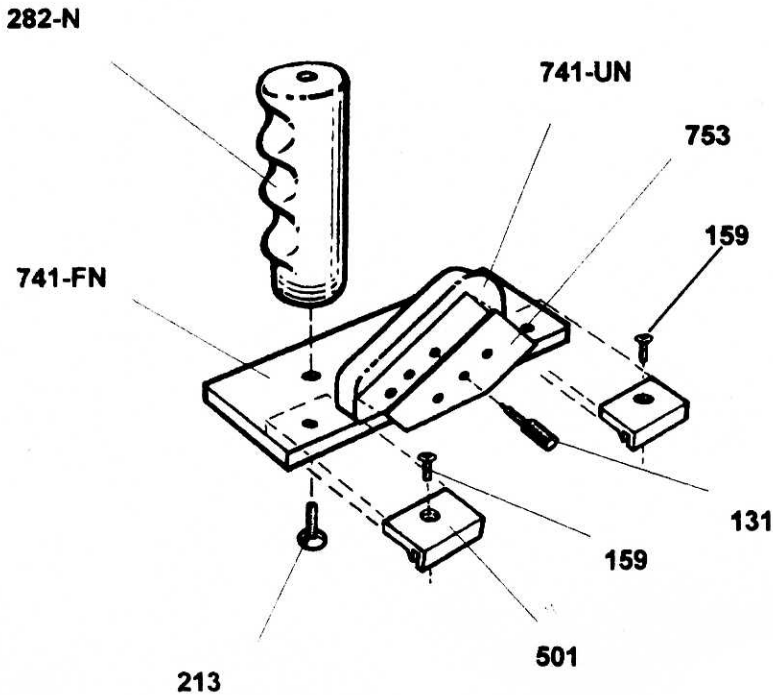

### 701 Straight Cutting Head

282-N	Handle
741-UN	Upright Base
753	Blade Cover
159	Bearing Screw x2
131	Knurled Screw
501	Bearing x2
213	Screw
741-FN	Straight Cut Base

## B. Board

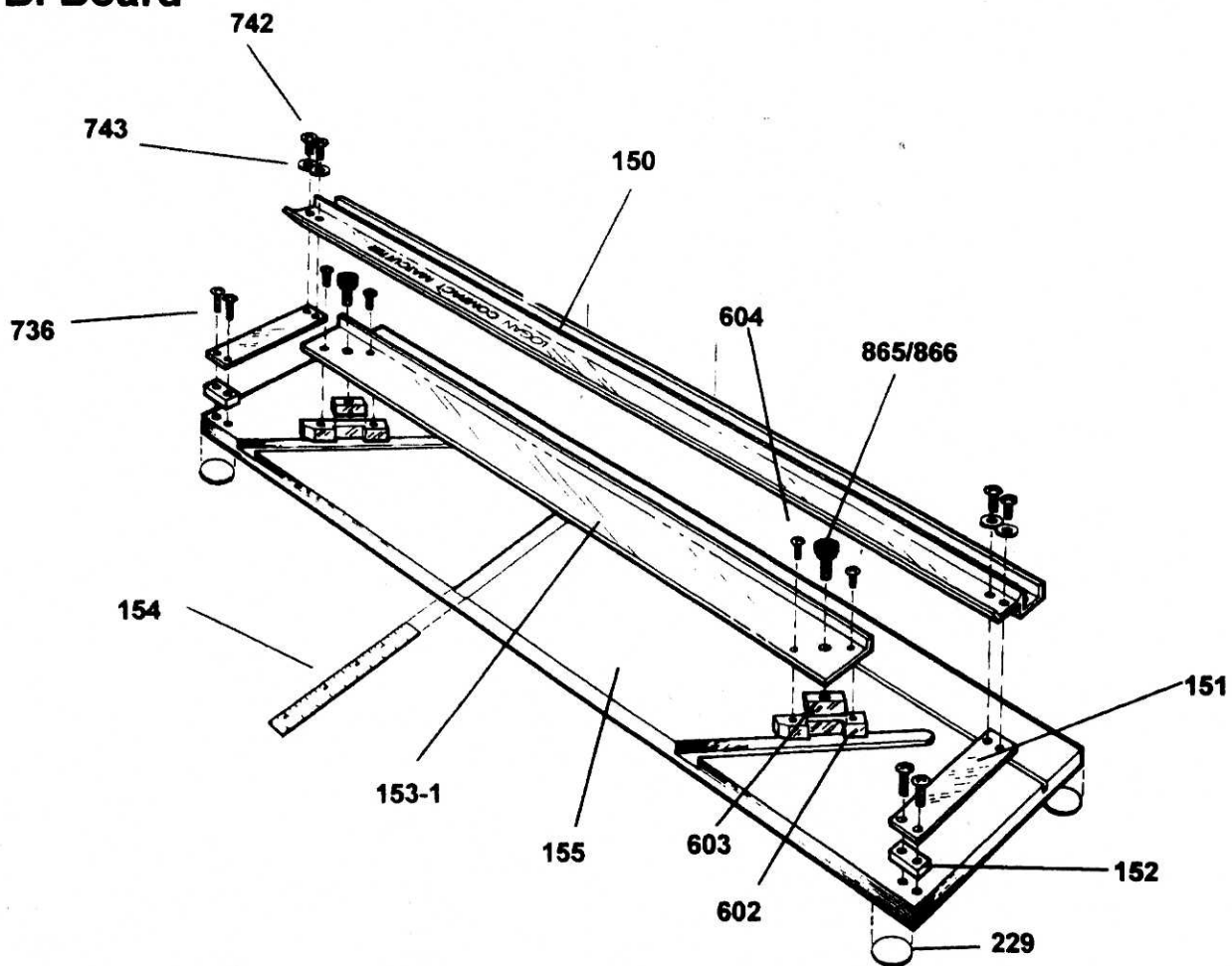

### 301 Compact Mat Cutter Board

150	Guide Rail
151	Support Arm (2)
152	Spacer Block (2)
153-1	Mat Guide
154	Scale
155	Cutting Board
229	Feet (4)
602	Mat Guide Slide (2)
603	Mat Guide Wedge (2)
736	Screw (4)
742	Screw (4)
743	Washer (4)
865/866	Knob (2)
604	Screws (4)

# Trouble Shooting

Problem	Solution
<b>Hooks or Curves</b>	<ul style="list-style-type: none"> <li>◆ Blade Depth set to deep (see page 5)</li> <li>◆ Blade is dull (see page 5)</li> <li>◆ Blade is catching on previous cut in Backing Sheet. (see page 3)</li> <li>◆ Uneven pressure being applied to Cutting during cut. (see page 4)</li> <li>◆ When entering the blade use a sharp, quick push with thumb.</li> </ul>
<b>Overcut on Top Cut</b>	<ul style="list-style-type: none"> <li>◆ Blade depth set too deep. (see page 5)</li> </ul>
<b>Overcut on Bottom Cut</b>	<ul style="list-style-type: none"> <li>◆ Adjust where you start in relation to scribe line.</li> </ul>
<b>Mat Borders Uneven</b>	<ul style="list-style-type: none"> <li>◆ Mat Guide not parallel (see page 5)</li> </ul>
<b>Ragged Bevel Cut</b>	<ul style="list-style-type: none"> <li>◆ Cutting without a Backing Sheet. (see page 3)</li> <li>◆ Backing Sheet is worn out. (see page 3)</li> <li>◆ Not changing blades often enough. (see page 3)</li> </ul>
<b>Not Cutting Through</b>	<ul style="list-style-type: none"> <li>◆ Machine not on a level surface (see page 3)</li> <li>◆ Not using a Backing Sheet as least as long as the mat as you are cutting. (see page 3)</li> <li>◆ Backing sheet not as wide as the Guide Rail. (see page 3)</li> <li>◆ Blade depth set too shallow. (see page 5)</li> </ul>
	<div data-bbox="1105 1591 1414 1812" style="text-align: right;">  <p><b>LOGAN</b> GRAPHIC PRODUCTS, INC.</p> </div>